



SILIGURI (WEST BENGAL)

A JUNCTION OF JOURNEYS WHERE EVERY PATH LEADS TO A PROMISE

YOUR PREMIER DESTINATION FOR
LUXURY, LEISURE AND **EVERYDAY ELEGANCE**



Iconic Mixed-Used Development Spanning Across **Impressive 7,00,000 sq. ft.**



Radisson Blu Hotel



Experience world-class
hospitality and timeless
elegance at the **luxurious**
100+ key Radisson Blu Hotel.

Grade A - Office Spaces



OFFICE LOBBY

The **Grade A Office** spaces ensure consistent weekday footfalls, adding vibrancy to the overall development.

Unmatched Shopping Experience



ATRIUM

Where each curated brand
and every corner sparks
excitement...

85+ National & International Brand



RETAIL

Tailored Brand Portfolio for diverse taste including **7 Anchors** and **80+ Vanilla Shops**.

Detail for Retail...

- **Prime Location:** Situated on Asian Highway AH2, ensuring high connectivity and effortless access.
- **Exceptional Visibility:** Over 600 feet of highway frontage, offering strong brand presence and recall.
- **City Profile:** Located in Siliguri - the third-largest city in West Bengal with a population of 10,00,000+.
- **Catchment Strength:** Draws shoppers not only from Siliguri but also from neighbouring cities, and benefits from a sizeable tourist population year-round.
- **Excellent Connectivity:** Bagdogra Airport - 12 km & Siliguri Junction Railway Station - 3 km
- **Economic Backbone:** The city thrives on the 3 Ts - Tea, Timber, and Tourism, along with a strong base in Trading.
- **Tourism Gateway:** Siliguri is key transit hub for tourists heading to Darjeeling, Kalimpong, Kurseong, and Gangtok, making it an unmissable stopover point.



About Location



Simulguri
সিমুলগুড়ি

Amhari
আমহারি

Located at a very strategic location in the west on **AH2**- just **3km from Railway Station** and **12 km from Airport**.

Site Plan



Ground Floor

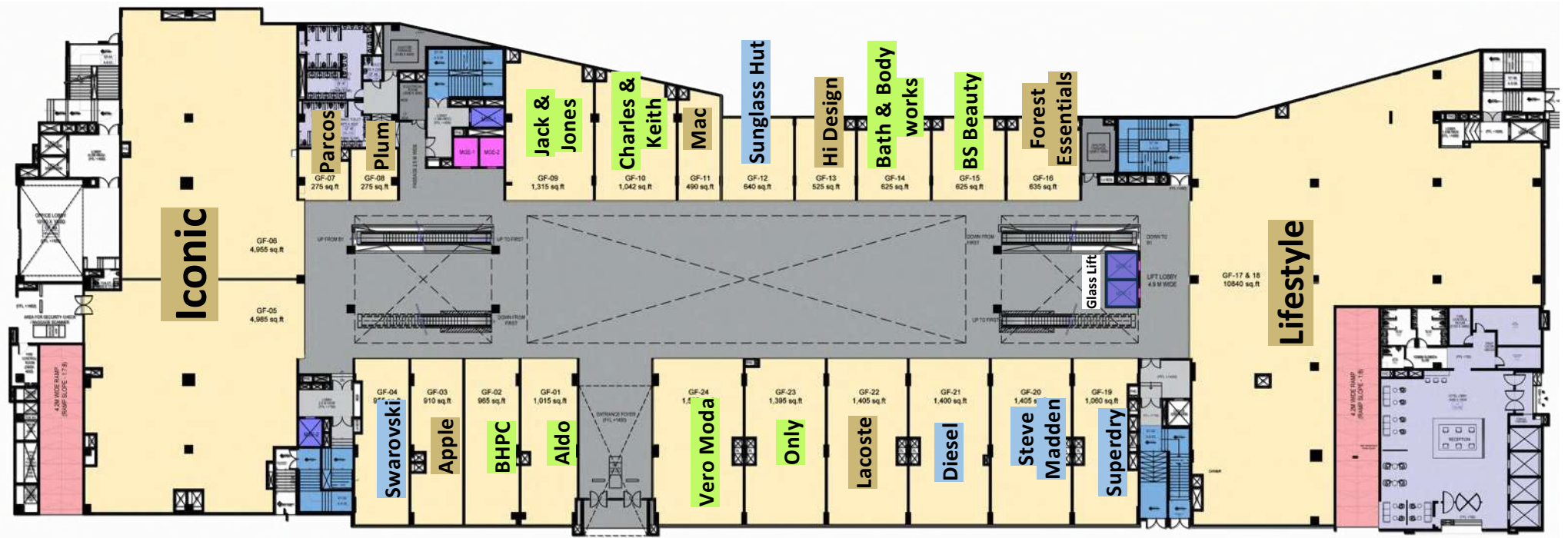

Brands Confirmed	
Brands Interested	
Brands Proposed	

First Floor

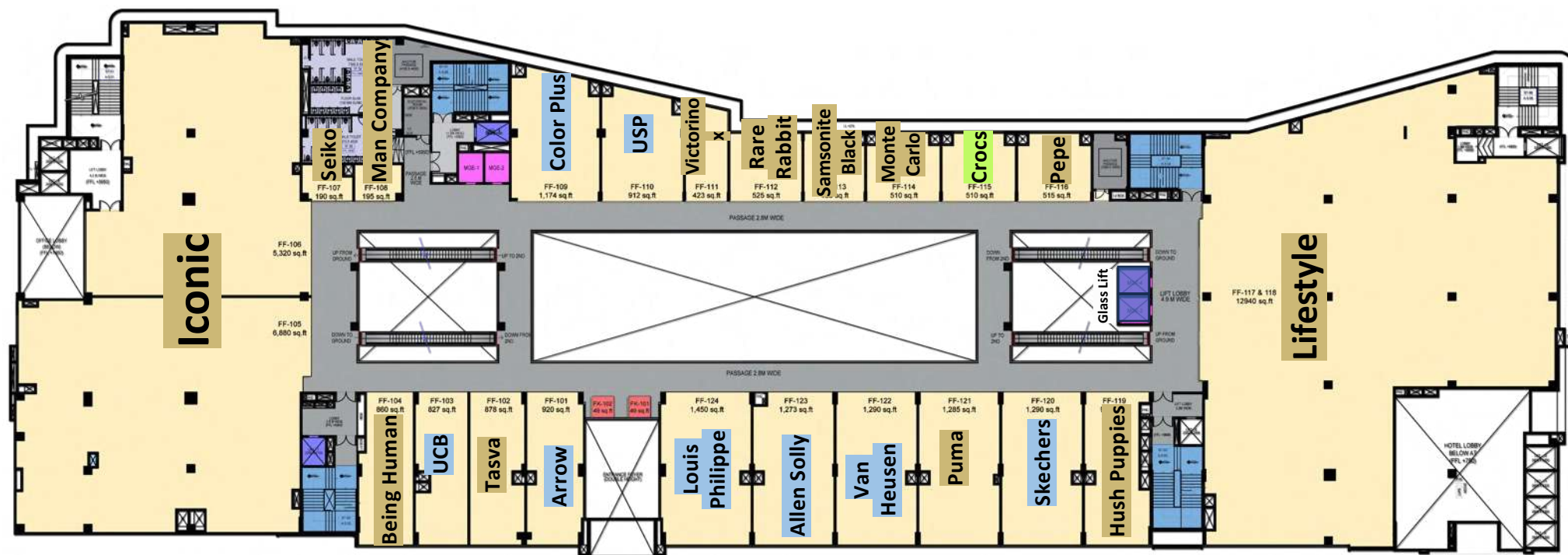

Brands Confirmed	
Brands Interested	
Brands Proposed	

Second Floor

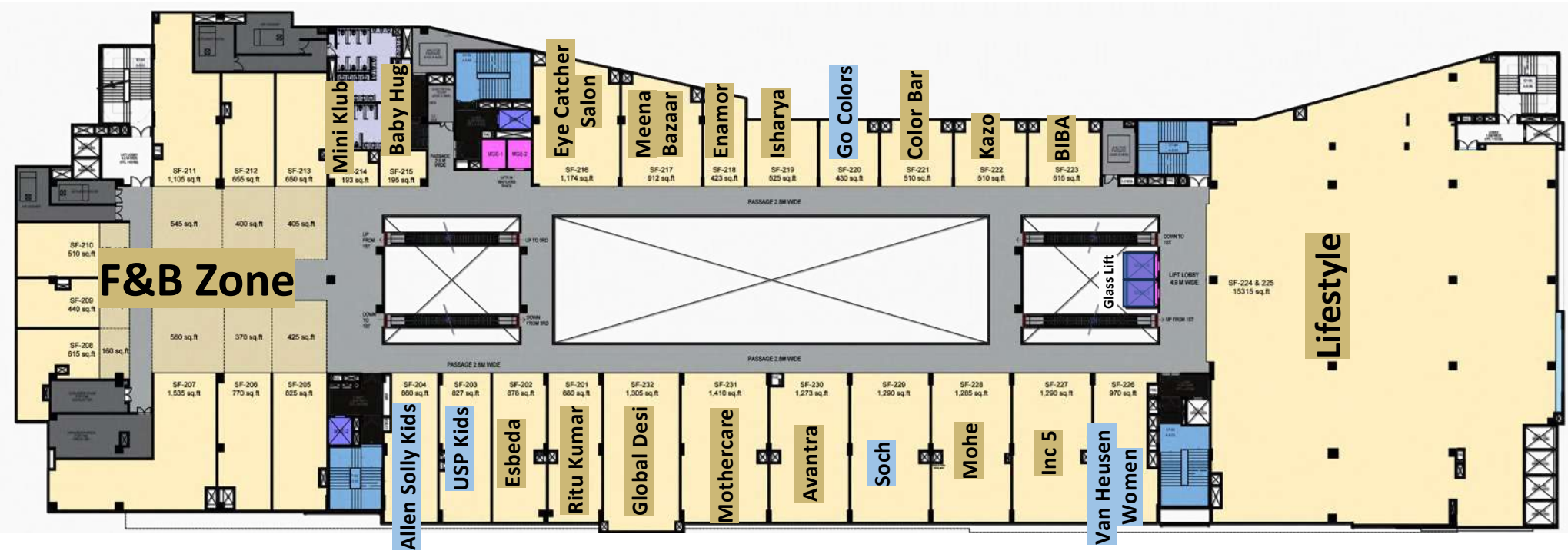

Brands Confirmed	
Brands Interested	
Brands Proposed	

Third Floor

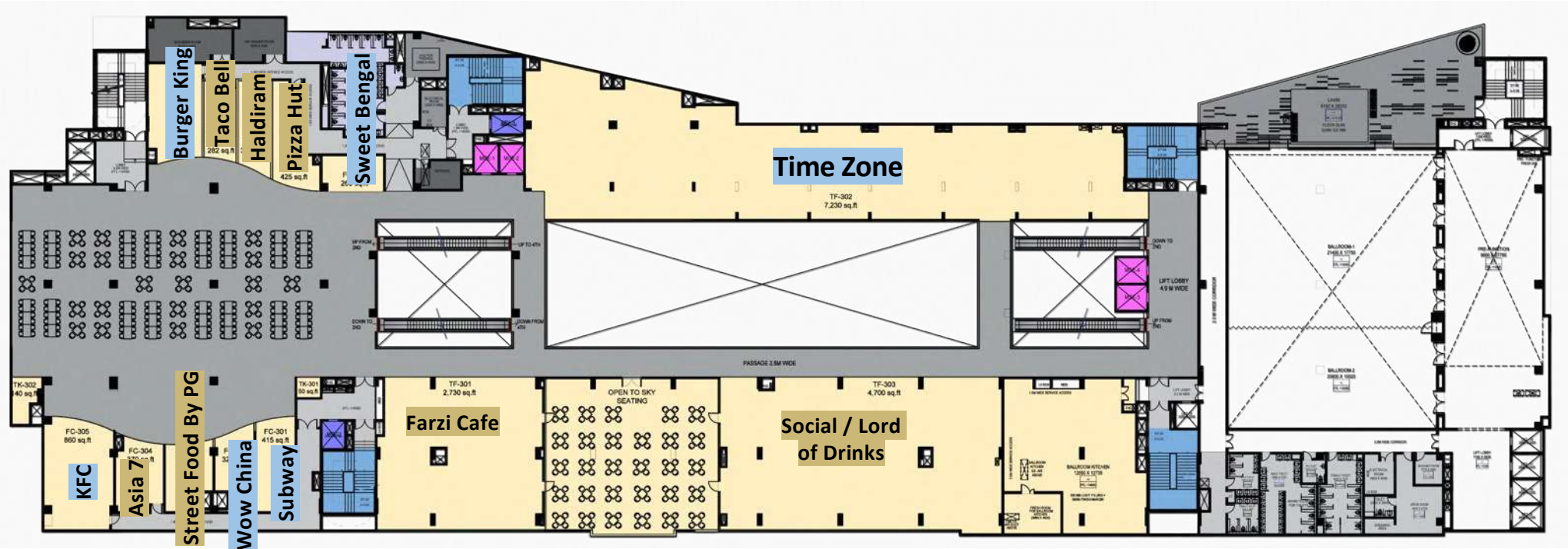

Brands Confirmed	
Brands Interested	
Brands Proposed	

Fourth Floor

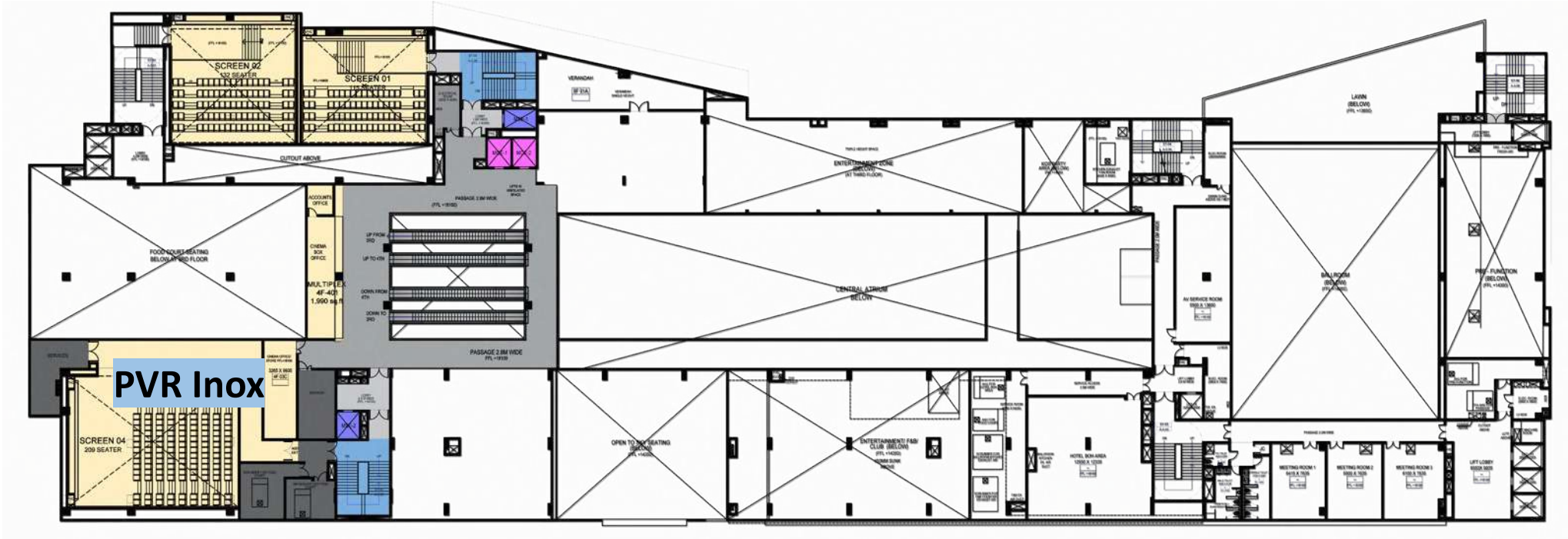

Brands Confirmed	
Brands Interested	
Brands Proposed	

Hypermarket



HYPERMARKET

Discover unbeatable value and variety at our **one-stop premium hypermarket** for all your shopping needs!

Food & Beverages



Savor exceptional flavors with curated food and beverage offerings in our **500+ seater Food Court** and **10+ Restaurants**.

Family Entertainment Center



KIDS AREA



ARCADE GAME ZONE

Experience nonstop fun and excitement for all ages at our Family Entertainment Center

Multiplex



Enjoy the latest blockbusters in ultimate comfort at our state-of-the-art 4 Screen with 750+ seats
multiplex cinema!

Car Parking



500+ Car parks for Hassle Free Parking Experience And Smooth Transition.

Parking - Basement 2



Parking - Basement 3



Current Site Status

**Scheduled
Launch
Q4 – 2026**

An Icon is taking shape.!

Siliguri's lifestyle is reimaged here...



Concurrently Leasing..



CDR Mall (Madurai)



Avenues Mall (Erode)



Grand Galleria (Purnea)



City Centre (Asansol)



Langval Mall (Thanjavur)

Exclusively Marketed & Leased By



Leaseline +91-90041-41256
leasing@beyondsquarefeet.com

